

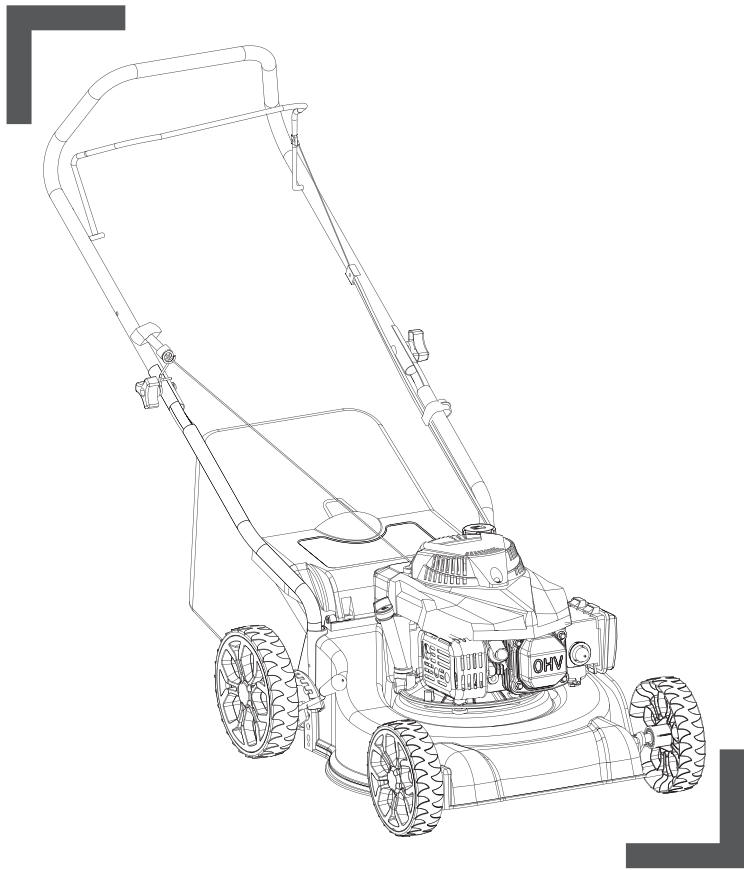

# Petrol Lawnmower 99 cm<sup>3</sup>



Original Instructions\_MNL\_FPLMP99H-4\_GB\_V6\_200911

## FPLMP99H-4

EAN: 5059340124551

V50920 / BX220IM



**WARNING: Read the instructions before using the machine.**

# Let's get started...

These instructions are for your safety. Please read through them thoroughly before use and retain them for future reference.



## Getting **started...** 02

<b>Technical and legal information</b>	03
<b>Technical specifications</b>	15
<b>Your product</b>	17
<b>Before you start</b>	19
<b>Quick start</b>	25



## In more **detail...** 26

<b>Product functions</b>	27
<b>Operation</b>	30
<b>Care and maintenance</b>	34
<b>Troubleshooting</b>	43
<b>Recycling and disposal</b>	45
<b>Guarantee</b>	45
<b>EC declaration of conformity</b>	46

## Safety warnings

### Petrol powered lawnmowers safety warnings



**IMPORTANT** Read carefully before use.  
Keep for future reference.



**WARNING!** Your safety and the safety of others is very important. Of course, it is not practical or possible to warn you about all the hazards associated with operating or maintaining this product. At all times you must use your own good judgment.

Getting started...

### Training

1. Read the instructions carefully. Be familiar with the controls and the proper use of the product.
2. Never allow children or people unfamiliar with these instructions to use the product. Local regulations can restrict the age of the operator.
3. Never mow while people, especially children, or pets are nearby.
4. Keep in mind that the operator or user is responsible for accidents or hazards occurring to other people or their property.
5. The operators must receive proper training in the use, adjustment and operation of the product, including prohibited operations.

## Safety warnings

### Preparation

1. While mowing, always wear substantial footwear and long trousers. Do not operate the product when barefoot or wearing open sandals.
2. Thoroughly inspect the area where the product is to be used and remove all objects which can be thrown by the product.
3. **WARNING** - Petrol is highly flammable.
  - Store fuel in containers specifically designed for this purpose.
  - Refuel outdoors only and do not smoke while refuelling.
  - Add fuel before starting the engine. Never remove the fuel tank cap or add petrol while the engine is running or when the engine is hot.
  - If petrol is spilt, do not attempt to start the engine but move the product away from the area of spillage and avoid creating any source of ignition until petrol vapours have dissipated.
  - Replace all fuel tank and container caps securely.
4. Replace faulty silencers.
5. Before using, always visually inspect to see that the cutting devices, cutting device bolts and cutter assembly are not worn or damaged. Replace worn or damaged cutting devices and bolts in sets to preserve balance.
6. **CAUTION!** Do not touch rotating cutting device.
7. Engine brake (brake lever (2)): Use the brake lever (2) to stop the engine. When you release the lever, the engine and the blade stop automatically in a few second. To mow, hold the lever in the working position. Before you start to mow, check the brake lever (2) several times to be sure that it is working properly.

Ensure that the brake wire (3) can be smoothly operated (i.e. is not catching or kinking in any way).

## Operation

1. Do not operate the engine in a confined space where dangerous carbon monoxide fumes can collect.
2. Mow only in daylight or in good artificial light.
3. Do not operate the product while being tired, ill or under influence of alcohol or drugs.
4. Avoid operating the product in wet grass, where feasible.
5. Always be sure of your footing on slopes.
6. Walk, never run.
7. Mow across the face of slopes, never up and down.
8. Exercise extreme caution when changing direction on slopes.
9. Do not mow excessively steep slopes near drop-offs, ditches or embankments.
10. Avoid using the product in bad weather conditions especially when there is a risk of lightning.
11. Use extreme caution when reversing or pulling the product towards you.
12. Stop the cutting device(s) if the product has to be tilted for transportation when crossing surfaces other than grass, and when transporting the product to and from the area to be mowed.
13. Never operate the product with defective guards, shields, or without safety devices, for example deflectors and/or grass catchers, in place.
14. Do not change the engine governor settings or overspeed the engine.
15. Do not alter or tamper with any sealed adjustments for the engine speed control.
16. Do not tamper or disable any product's safety systems or features.

## Safety warnings

17. Ensure and regularly check that all starting interlocks and operator presence controls are properly functioning.
18. Stop the product according to instructions in this manual before leaving the operator's position and park it in a safe location.
19. Start the engine or switch on the engine carefully according to instructions and with feet well away from the cutting device(s).
20. Do not tilt the product when starting the engine or switching on the engine, except if the product has to be tilted for starting. In this case, do not tilt it more than absolutely necessary and lift only the part which is away from the operator. Always ensure that both hands are in the operating position before returning the appliance to the ground.
21. Keep hands and feet away from the cutting means at all times and especially when switching on the engine.
22. Do not put hands or feet near or under rotating parts. Keep clear of the discharge opening at all times.
23. Never pick up or carry a product while the engine is running.
24. In case of any situation mentioned below, stop the engine and disconnect the spark plug connector, make sure that all moving parts have come to a complete stop and, where a key is fitted remove the key:
  - before clearing blockages or unclogging chute,
  - before checking, cleaning or working on the product,
  - after striking a foreign object. Inspect the product for damage • and make repairs before restarting and operating the product,
  - if the product starts to vibrate abnormally (check immediately).

- >inspect for damage
  - >replace or repair any damaged parts
  - >check for and tighten any loose parts
  - whenever you leave the product,
  - before refuelling.
25. Never touch the exhaust, exhaust guard or cooling fins when the engine is hot.
  26. Never carelessly touch hot parts of the product, you can burn yourself. While the product is in operation or shortly thereafter, its parts such as the exhaust pipe, engine, and other surfaces are extremely hot! Pay attention to the markings on the product.
  27. Make sure that the air vents of the combustion engine are clear. Keep the air vents free of dust, dirt particles, gases and fumes.
  28. Never start or run the engine indoors. The exhaust fumes are dangerous, containing carbon monoxide, an odourless and deadly gas. Operate this product only in well ventilated outdoor areas.

## Maintenance and storage

1. Follow the maintenance and repair instructions for this product. Never carry out any modifications of the product. Never change the preset rotary speed or the engine and product settings. Information about maintenance and repair is provided in this user manual.
2. Keep all nuts, bolts and screws tight to be sure the product is in safe working condition.
3. Improper maintenance, using non-genuine parts, or removing / modifying safety components may lead to malfunction / failure of the product and injury of operators. Many accidents are caused by poorly maintained products.

## Safety warnings

4. Never store the product with petrol in the tank inside a building where fumes can reach an open flame or spark.
5. To reduce the fire hazard, keep the engine, silencer and petrol storage area free of grass, leaves, or excessive grease to reduce the fire hazard.
6. Allow the engine to cool before storing in any enclosure. Clean and maintain the product before storage.
7. Check the grass catcher frequently for wear or deterioration.
8. If the fuel tank has to be drained, this should be done outdoors.
9. Wear strong work gloves when removing and re-assembling the cutting device.
10. Replace worn or damaged parts for safety. Use only the genuine replacement parts and spare parts.
11. Ensure that only replace the recommended cutting means (blade) with the right type.

## Fuel handling

1. Before refuelling, stop the engine, disconnect the spark plug connector and let the product cool. Fuel and fuel vapours are highly flammable. Take care when handling fuel. Never smoke when you are refuelling the product. Do not refuel the product, if there is an open fire in the vicinity!
2. Always use suitable aids such as funnels and filler necks. Do not spill any fuel on the product or its exhaust system. There is a risk of ignition. However, if fuel should be spilled, then you must remove it carefully from all parts of the product. Any residue which may be present must be completely removed, before the product is operated!





3. Never refuel indoors. Exhaust gases and fuel fumes are noxious.
4. Never use the product in environments where there is a risk of explosion. Fuel fumes can ignite.
5. Never breathe in any fuel fumes, when you are refuelling the product. Never fill the tank in enclosed spaces, such as basements or sheds. There is a risk of poisoning and explosion!
6. Avoid skin contact with petrol.
7. Do not eat or drink, while you are refuelling the product. If you have swallowed petrol or oil, or if petrol or oil has got into your eyes, then seek medical advice immediately.
8. Close the fuel tank cap immediately after filling the fuel tank. Make sure that it is properly closed.
9. Never use the product without an air filter.
10. Fuel vapour pressure may build up inside the fuel tank depending on the fuel used, weather conditions and the tank venting system. To reduce the risk of burns and other personal injuries, remove the fuel cap carefully to allow any pressure build up to release slowly.
11. Be aware of fire risks, explosion and inhalation risks.
12. Do not smoke while operating the product, handling fuel or near fuel.
13. Ensure the spark plug lead is secured; a loose lead may cause electrical arcing that could ignite combustible fumes and cause a fire or explosion.
14. Check regularly for leaks from the fuel cap and fuel lines.
15. Do use caution when handling fuel. To avoid any accidental fires, move the product at least 3 metres (10') from the fuelling point before starting the engine.
16. Tighten the fuel tank cap thoroughly after refilling the fuel tank.

## Safety warnings

17. Do not operate the product if it is leaking fuel. Do not remove the fuel tank cap while the engine is running.
18. Use only an approved container for this purpose.
19. Do not store cans of fuel or refill the fuel tank in any place where there is a boiler, stove, wood fire, electrical sparks, welding sparks, or other sources of heat or fire which might ignite the fuel.
20. If any fuel spillage occurs during refuelling, use a dry rag to wipe up spills and allow remaining fuel to evaporate before turning the engine on again.
21. If you have spilt fuel on yourself or on your clothes, change your clothes and wash any part of your body that has come in contact with fuel before turning the engine on again.
22. If fuel is ignited, put out the fire with a dry powder fire extinguisher.
23. If the fuel tank is drained, this should be done outdoors.

### Vibration and noise reduction

**To reduce the impact of noise and vibration emission, limit the time of operation, use low-vibration and low-noise operating modes as well as wear personal protective equipment.**

Take the following points into account to minimize the vibration and noise exposure risks:

1. Only use the product as intended by its design and these instructions.
2. Ensure that the product is in good condition and well maintained.
3. Use correct attachments for the product and ensure they are in good condition.
4. Keep tight grip on the handles/gripping surface.

5. Maintain this product in accordance with these instructions and keep it well lubricated (where appropriate).
6. Plan your work schedule to spread any high vibration tool use across a longer period of time.

## Emergency

**Familiarise yourself with the use of this product by means of this instruction manual. Memorise the safety directions and follow them to the letter. This will help to prevent risks and hazards.**

1. **Always be alert when using this product, so that you can recognize and handle risks early.** Fast intervention can prevent serious injury and damage to property.
2. **Stop the engine and disconnect the spark plug connector if there are malfunctions.** Have the product checked by a qualified professional and repaired, if necessary, before you operate it again.
3. **In case of fire stop the engine and disconnect the spark plug connector.** Take fire-extinguishing measures immediately if the product switch is no longer accessible.



**WARNING!** Never use water to extinguish a product on fire. Burning fuel must be extinguished with special extinguishing agents! We recommend that you keep a suitable fire extinguisher within reach in your work area!

## Residual risks

**Even if you are operating this product in accordance with all the safety requirements, potential risks of injury and damage remain. The following dangers can arise in connection with the structure and design of this product:**

## Safety warnings

1. Health defects resulting from vibration emission if the product is being used over long periods of time or not adequately managed and properly maintained.
2. Injuries and damage to property due to broken application tools or the sudden impact of hidden objects during use.
3. Danger of injury and property damage caused by flying objects.
4. Burns, if touching hot surfaces.



**WARNING!** This product produces an electromagnetic field during operation! This field may under some circumstances interfere with active or passive medical implants! To reduce the risk of serious or fatal injury, we recommend persons with medical implants to consult their doctor and the medical implant manufacturer before operating this product!

## Symbols

On the product, the rating label and within these instructions you will find among others the following symbols and abbreviations. Familiarise yourself with them to reduce hazards like personal injuries and damage to property.

kW	Kilowatt	ml	Millilitre
cm <sup>3</sup>	Cubic centimetre	g/kWh	Gram per kilowatt per hour
/min or min <sup>-1</sup>	Per minute	kg/h	Kilogram per hour
mm	Millimetre	°C	Degree Celsius
cm	Centimetre	dB(A)	Decibel (A-rated)
kg	Kilogram	m/s <sup>2</sup>	Metres per seconds squared
l	Litre		
mm.yyyy	Manufacturing date code, year of manufacturing (yyyy) and month of manufacturing (mm)		



Lock / to tighten or secure.



Unlock / to loosen.



**CAUTION!**  
**WARNING!**  
**DANGER!**  
**NOTE:**



**CAUTION / WARNING!**  
Read the instruction manual.



Wear hearing protection.  
Wear eye protection.



Wear respiratory protection.



Wear protective gloves.



Wear protective, slip-resistant footwear.



Wear tight-fitted protective clothes.



Do not expose the product to rain or wet conditions.



Open flames in the work area, around the product and in the vicinity of flammable materials are prohibited!



Do not smoke in the work area, around the product and in the vicinity of flammable materials!



Risk of fire / flammable materials



Hot surface, do not touch! High temperatures on the product's surfaces and structural parts that could cause burns, if they are touched. The product can also stay hot for a longer period of time after operation!



This product produces noxious exhaust fumes. If the product is used improperly, these fumes can lead to poisoning, a loss of consciousness or death!



Noxious exhaust fumes; do not operate or start the product in indoor rooms!



Keep hands and feet away.



**CAUTION / WARNING!**  
Only refuel unleaded petrol!

## Symbols



Add engine oil.

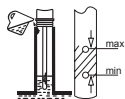

Check and refill oil.



Switch the engine off while you are refilling the tanks!

Fuel is flammable, keep fire away. Do not add fuel with running engine.



Press the primer 3 times before starting the cold engine.



Mow across the face of slopes, never up and down.



Inspect the area where the product is to be used and remove all objects which can be thrown by the product.

If objects are hidden while operating, stop the engine and remove the object.



Keep hands and feet away from sharp rotating parts – danger of injury! When cleaning, repairing, or inspecting, make certain the cutting device and all moving parts have stopped. Disconnect the spark plug connector, and keep the connector away from the plug to prevent accidental starting.



Stop the engine and disconnect the spark plug connector before assembly, cleaning, adjustments, maintenance, storage and transportation.



Cutting device continues to rotate after the product is switched off. Wait until all machine components have completely stopped before touching the product.



Pay special attention when working on the cutting device!



Objects thrown by the product could hit the user or other bystanders. Always ensure that other people and pets remain at a safe distance from the product when it is in operation. In general, children must not come near the area where the product is.



Release the brake lever (2) to stop the engine and blade.



Engine manual start; recoil starter.



Guaranteed sound power level value in 96 dB.



The product complies with the applicable European directives and an evaluation method of conformity for these directives was done.

## Rating label explanation

### Petrol Lawn Mower: FPLMP99H-4= MODEL NUMBER

FP = Brand name

LM = Lawn Mower

P = Petrol

99 = Engine displacement (cm<sup>3</sup>)

H = Hand push

## Technical specifications

### General

- > **Dimensions** : approx. 1330 x 500 x 400 mm
- > **Machine mass with empty tanks and in normal operating configuration** : approx. 18,5 kg
- > **Fuel tank capacity** : 1000 ml (cm<sup>3</sup>)
- > **Petrol type** : #93, unleaded
- > **Engine oil capacity** : 400 ml (cm<sup>3</sup>)
- > **Engine oil type** : 4-stroke engine oil (e.g. SAE 10W-30)
- > **Specific fuel consumption at max. engine power** : 395 g/kWh
- > **Fuel consumption at max. engine power** : 0,60 g/kWh
- > **Cutting device** : 10012587, Thickness 2,5 mm
- > **Cutting width** : 40 cm
- > **Cutting height** : 25-75 mm
- > **Grass catcher volume** : 45 l
- Engine**
- > **Engine model** : GP99
- > **Engine type** : air cooled, 4-stroke engine
- > **Engine displacement** : 99 cm<sup>3</sup>
- > **Maximum operating engine speed (rotational frequency)** : 2900 min<sup>-1</sup>
- > **Nominal power** : 1,2 kW

Getting started...

## Technical specifications

- > **Spark plug type** : F7RTC
- > **Spark plug gap** : 0,7-0,8 mm
- > **Carburetor** : 1P56F

### Sound level

- > **Sound pressure level at operator's position  $L_{pA}$**  : 81,6 dB(A)
- > **Uncertainty K** : 3,0 dB(A)
- > **Sound power level  $L_{WA}$**  : 91,00 dB(A)
- > **Uncertainty K** : 4,03 dB(A)
- > **Guaranteed sound power level  $L_{WA}$  (acc. to 2000/14/EC amended by 2005/88/EC)** : 96 dB(A)

### Vibration level

- > **Hand arm vibration  $a_{hw}$**  : 2,658 m/s<sup>2</sup>
- > **Uncertainty K** : 1,5 m/s<sup>2</sup>

The sound values have been determined according to noise test code given in EN ISO 5395-1 and EN ISO 5395-2, using the basic standards ISO 3744 and ISO 11094.

Wear hearing protection, especially when sound pressure is over 80 dB(A).

The declared vibration value has been measured in accordance with a standard test method (according to EN ISO 5395-1 and EN ISO 5395-2) and may be used for comparing one product with another. The declared vibration value may also be used to evaluate the exposure for the user caused by vibration in advance.



**WARNING!** Depending on the actual use of the product the vibration values can differ from the declared total! Adopt proper measures to protect yourself against vibration exposures. Take the whole work process including times the product is running under no load or switched off into consideration.

Proper measures include among others regular maintenance and care of the product and application tools, keeping hands warm, periodical breaks and proper planning of work processes.





# Your product

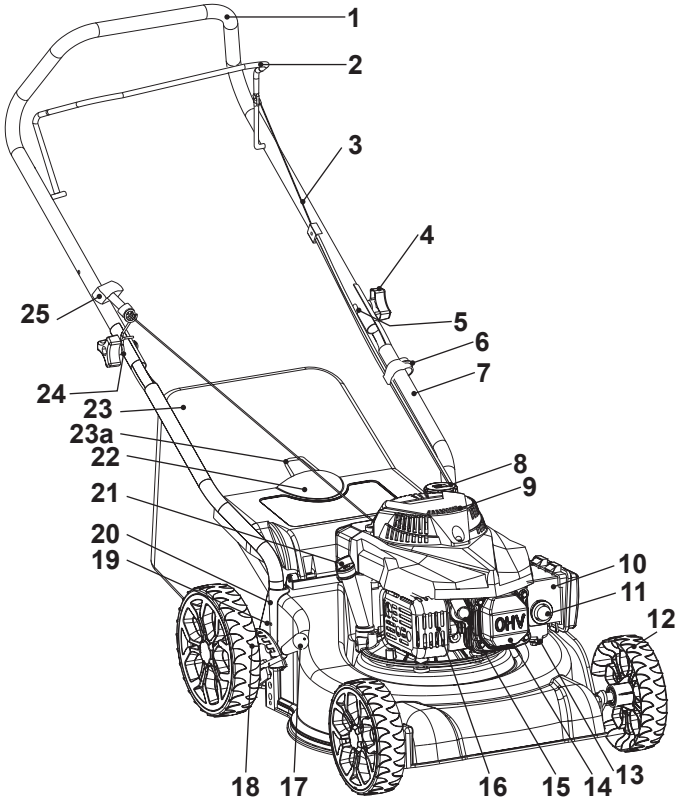

Getting started...

## Your product

Getting started...

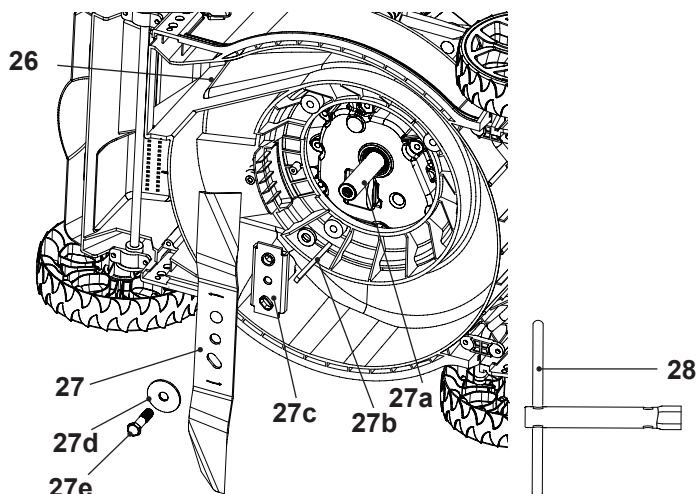

- |   |                                    |
|---|------------------------------------|
| 1. Upper handle bar                     | 18. Rear wheel (x2)                |
| 2. Brake lever                          | 19. Handle support screw (x2)      |
| 3. Brake wire                           | 20. Handle support                 |
| 4. Mounting knob (x2)                   | 21. Oil tank cap                   |
| 5. Mounting bolt (x2)                   | a) Oil drain screw                 |
| 6. Wire clip                            | 22. Rear deflector guard           |
| 7. Lower handle bar (x2)                | 23. Grass catcher                  |
| 8. Fuel tank cap                        | a) Carry handle                    |
| 9. Air vents                            | b) Hook*                           |
| 10. Air filter case                     | c) Rod*                            |
| a) Air filter*                          | d) Rear handle*                    |
| b) Cover*                               | e) Rubber clips*                   |
| c) Latch*                               | 24. Hook for recoil starter handle |
| 11. Primer                              | 25. Recoil starter handle          |
| 12. Front wheel (x2)                    | 26. Discharge chute                |
| 13. Carburetor                          | 27. Cutting device (blade)         |
| a) Fuel drain screw*                    | a) Spindle                         |
| 14. Engine                              | b) Pin                             |
| 15. Spark plug connector                | c) Blade holder                    |
| a) Spark plug*                          | d) Cup washer                      |
| 16. Muffler                             | e) Hex bolt                        |
| 17. Lever for cutting height adjustment | 28. Spark plug wrench              |



**NOTE:** Parts marked with \* are not shown in this overview. Please refer to the respective section in the instruction manual.

## Unpacking



**NOTE:** The product is heavy, ask another person for assistance if required.

1. Unpack all parts and lay them on a flat, stable surface.
2. Remove all packing materials and shipping devices, if applicable.
3. Make sure the delivery contents are complete and free of any damage. If you find that parts are missing or show damage do not use the product but contact your dealer. Using an incomplete or damaged product represents a hazard to people and property.
4. Ensure that you have all the accessories and tools needed for assembly and operation. This also includes suitable personal protective equipment.



**WARNING!** The product and the packaging are not children's toys! Children must not play with plastic bags, sheets and small parts! There is a danger of choking and suffocation!

## You will need

### (items not supplied)

Suitable personal protective equipment  
 Fuel funnel with filter  
 Petrol and engine oil  
 Fuel collecting container  
 Oil collecting container  
 Lubrication oil/grease  
 Suitable torque wrench  
 Suitable screwdriver

### (items supplied)

Grass catcher (23)  
 Spark plug wrench (28)

## Assembly



**WARNING!** The product must be fully assembled before operation! Do not use a product that is only partly assembled or assembled with damaged parts!



Follow the assembly instructions step-by-step and use the pictures provided as a visual guide to easily assemble the product!  
 Disconnect the spark plug connector (15) from the spark plug!  
 Reconnect it after assembly.

## Assembly



**NOTE:** Take care of small parts that are removed during assembly or when making adjustments. Keep them secure to avoid loss.

### Low handle bars

1. Put the product on the ground.
2. Insert the lower handle bars (7) into the handle supports (20). Align the mounting holes of the lower handle bars (7) and the handle supports (20) (Fig. 1, step 1).
3. Secure the lower handle bars (7) with the handle support screws (19) using the suitable screwdriver (not delivered) (Fig. 1, step 2).



**NOTE:** The position of mounting holes can be lift by adjusting the cutting height for the convenience, if necessary.

4. Make sure the brake wire (3) run on the upper side of the lower handle bar (7).

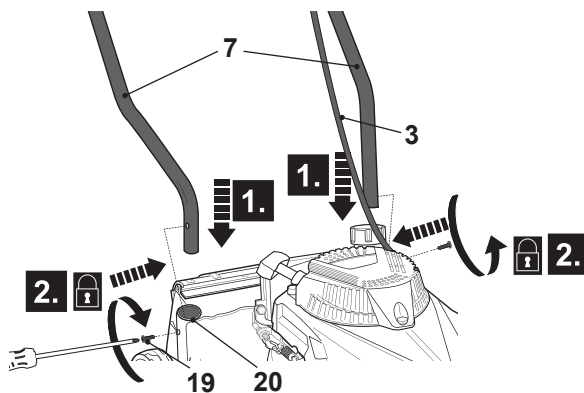

Fig. 1

### Upper handle bar

1. Hold the upper handle bar (1) with the brake lever (2) facing upwards. Align the mounting holes of the upper handle bar (1) and the lower handle bars (7).
2. Pass the mounting bolt through the mounting holes to the end (Fig. 2, step 1).
3. Place the hook for recoil starter handle (24) with its pin positioned on the upper side of the upper handle bar (1) and secure it by turning the mounting knob (4) through the thread of the mounting bolt (5) (Fig. 2, step 2).
4. Pass the remaining mounting bolt through the mounting holes to the end (Fig. 3, step 1).
5. Make sure the brake wire (3) run on the upper handle bar (1).



6. Secure the bars on the other side by turning the remaining mounting knob (4) through the thread of the mounting bolt (5) (Fig. 3, step 2).

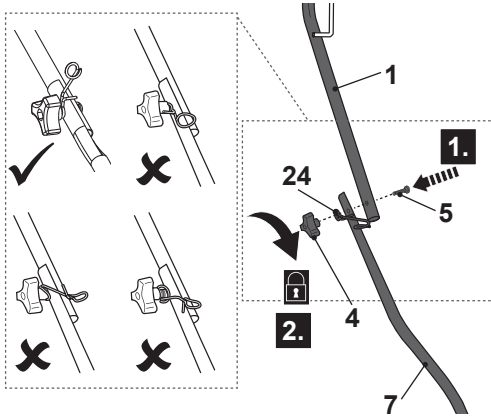

Fig. 2

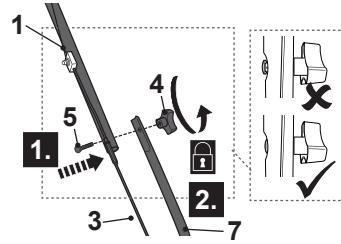

Fig. 3

7. Fix the brake wire (3) with the wire clip (6) on the lower handle bar (7) (Fig. 4).

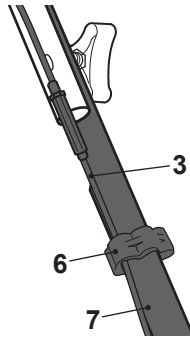

Fig. 4

## Assembly

### Grass catcher

1. The grass catcher (23) was already assembled, but make sure that the grass catcher rubber clips (23e) was secured on the supporting rod (23c) (Fig. 5) before use.

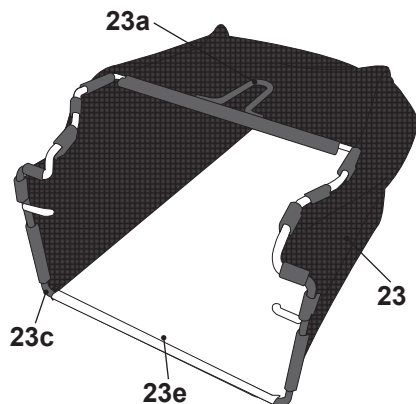

Fig. 5

2. Open the rear deflector guard (22) and hold it in position (Fig. 6, step 1).
3. Carry the grass catcher by its carry handle (23a).
4. Align the hooks (23b) with the slot and hang the grass catcher onto it (Fig. 6) correctly.

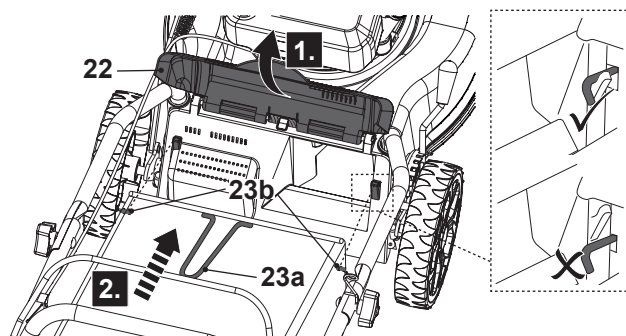

Fig. 6

5. Carefully release the rear deflector guard (22) afterwards.

## Fuel and engine oil

This product is equipped with a 4-stroke engine. Before operation it is necessary to add proper fuel and engine oil separately.

1. Place the product on a stable, level surface. We recommend laying a non-flammable sheet under the product.
2. Use proper funnels. Avoid spilling and overfilling the tanks.



**WARNING!** Fuel and oil are highly inflammable! Fumes will explode if lit! Ensure that there are no naked flames around the product! Do not smoke while filling fuel and oil!

3. Always dispose of fuel, used oil and objects contaminated with them in accordance with local regulations.

### Fuel



**NOTE:** This product is not supplied with fuel! Before operating this product it is essential to fill it with fuel! Fill fuel and engine oil separately. Never mix oil with petrol!

1. Always use clean, fresh unleaded petrol. Purchase fuel in quantities that can be used within 30 days.
2. Never mix oil with petrol. Avoid getting dirt, dust or water in the fuel tank.
3. Unscrew and remove the fuel tank cap (8) (Fig. 7).
4. Add suitable fuel into the fuel tank. Leave a minimum 5 mm of space between the top of the fuel and the inside edge of the tank to allow for expansion (Fig. 8).

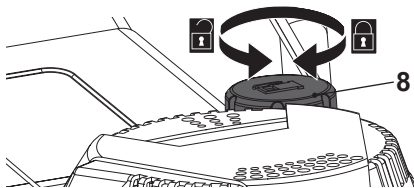

Fig. 7

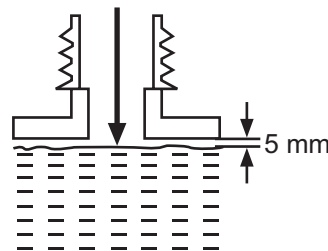

Fig. 8

## Fuel and engine oil



**NOTE:** Petrol deteriorates over time. It may be difficult to start the engine if you use petrol which has been kept for more than 30 days. Towards the end of the season, it is advisable to put only as much fuel in the tank as you need for each use, since it should be completely used up before storing the product.

Always empty the fuel tank when storing the product for over 30 days.

- Wipe any spilled fuel with a soft cloth and reattach the fuel tank cap (8).

### Engine oil



**WARNING!** This product is not supplied with oil. However, for manufacturing reasons it is possible that a small quantity may be in the engine! Before operating this product it is essential to fill it with proper oil (4-stroke engine oil, e.g. SAE 10W-30)!



Engine oil has a major influence on engine performance and service life. Non-detergent or 2-cycle engine oils will damage the engine and should not be used!

- Unlock and remove the oil tank cap (21) (Fig. 9).
- Gradually add good-quality engine oil (SAE10W-30). Allow the oil to settle.
- Check the oil level frequently while filling. Wipe the oil dipstick clean and insert it into the tank opening without tightening the cap, and then remove the dipstick again.
- The oil level must be between the “min” and “max” of the oil level markings. Add more oil if necessary. Do not overfill (Fig. 10).

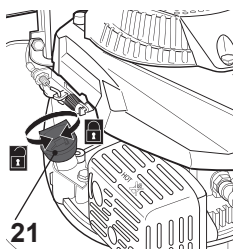

Fig. 9

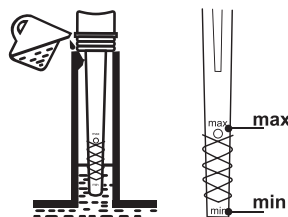

Fig. 10

- After adding oil, wait a minute and then recheck the oil level.
- Wipe spilled oil with a soft cloth and reattach the oil tank cap (21).





# Operating controls

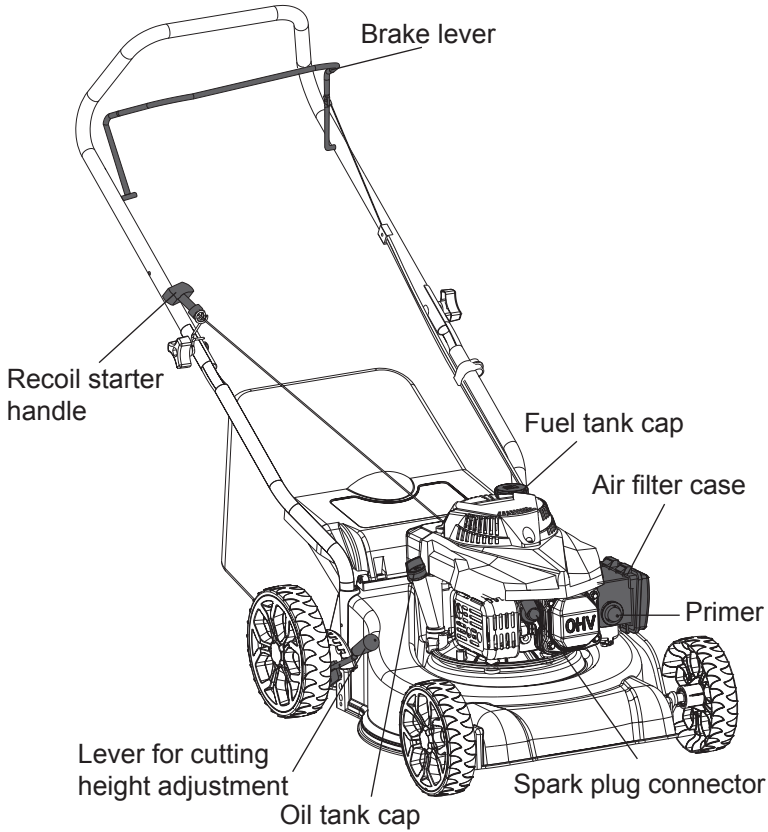

Getting started...

## Set up



Assemble



Adjust



Add fuel



Add oil

## Start



Press primer 3 times  
(for cold engine)



Pull back the  
brake lever (2)  
and hold it in  
position



Pull recoil starter  
handle (25) until  
engine starts



Operate

## Stopping



Release the  
brake lever (2)

## Storage



Empty fuel tank



Empty oil tank



Clean and  
maintain



Store



**WARNING!** This quick start provides only a short overview of how to start and stop the product! For safe use it is essential to read the entire instruction manual before first use!

## Intended use

This petrol lawnmower FPLMP99H-4 is designated with a power output of 1.2 kW.

The product is intended for mowing grass in domestic gardens only. It must not be used to mow unusually high, dry or wet grass, e.g. pasture grass, or to shred leaves.

For safety reasons it is essential to read the entire instruction manual before first operation and to observe all the instructions therein.

This product is intended for private domestic use only, not for any commercial trade use. It must not be used for any purposes other than those described.

## Brake lever

1. Pull back the brake lever (2) and hold it against the upper handle bar (1) when starting the engine. Keep it squeezed during operation (Fig. 11).
2. Release the brake lever (2) to stop the engine.

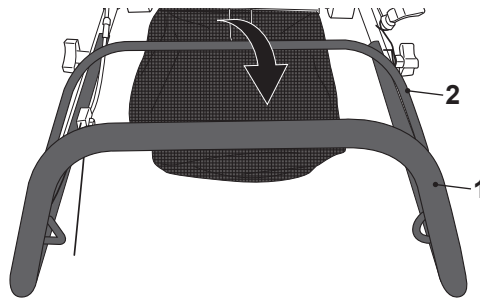

Fig. 11

## Recoil starter

The recoil starter handle (25) is positioned at the top of the engine.

1. Pull back the brake lever (2) and hold it against the upper handle bar (1) (Fig. 11).
2. Pull the recoil starter handle (25) lightly until you feel resistance then pull it rapidly. Do it repeatedly until the engine starts (Fig. 12).
3. Always rest the recoil starter handle (25) onto the hook (24) located on the right-hand side of the upper handle bar (1) (Fig. 13) when the recoil starter is not operated.

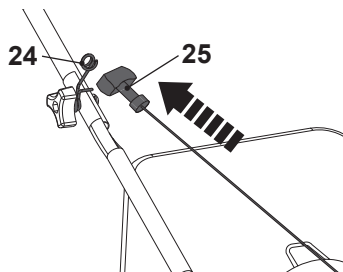

Fig. 12

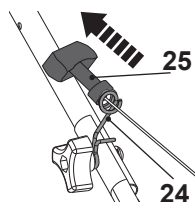

Fig. 13



**WARNING!** Never twist the starter cord around your hand! Only pull on the recoil starter handle (25)! Do not suddenly release the recoil starter handle (25)! Allow the starter cord to return slowly and in a controlled manner each time it is pulled!

## Grass catcher



**WARNING!** Do not attempt to use the product without the grass catcher attached when collecting grass – danger of flying objects! Switch the engine off and wait that the blade had come to a complete stop before removing the grass catcher!

1. Always attach the grass catcher (23) correctly when using the product for grass collection as described in the “Assembly - grass catcher” section.
2. Always carry the grass catcher by its handle (23a).

## Emptying



**WARNING:** Switch the engine off and wait that the blade had come to a complete stop before removing the grass catcher!

Empty the grass catcher (23) frequently during use. Do not wait until it is completely full. We recommend emptying when it is 90% full or there are trace of grass leakage on grass land.



**NOTE:** A full grass catcher (23) will reduce the performance of this product.

## Grass catcher

1. Lift the rear deflector guard (22) and hold it in place.
2. Lift the grass catcher hooks (23b) off the slots and remove the grass catcher (23).
3. Remove the grass clippings from the rear discharge chute (26) into the grass catcher (23). Use a proper tool such as a brush.
4. Remove the grass catcher (23) by its carry handle (23a).
5. Empty the grass clippings onto a compost heap by its carry handle (23a) and rear handle (23d).
6. Re-fit the grass catcher (23) onto the product and ensure the grass catcher hooks (23b) to stay correctly into the slots as described in the "Assembly - grass catcher" section.



**WARNING!** Never use your hands or feet to remove grass clippings from the discharge chute (26)!

## Cutting height adjustment

Adjust the cutting height according to the needs of your lawn. The cutting height depends on the kind of lawn and its actual height. When mowing high grass, start with the maximum cutting height and make a second cut with a lower cutting height.

1. Pull the lever for cutting height adjustment (17) towards the rear wheel (18) (Fig. 14, step 1), then move it forward or backward to the desired cutting height (Fig. 14, step 2).
2. Release the lever (17) and ensure it engages into place properly (Fig. 14, step 3).

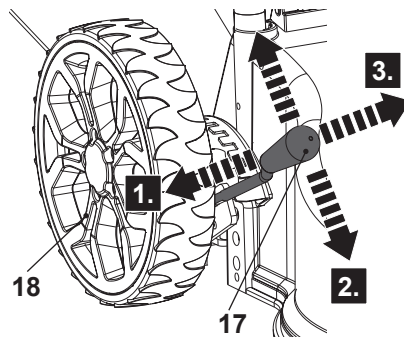

Fig. 14



**WARNING!** Ensure that the lever for cutting height adjustment (17) engages between two of the grooves!  
Switch the engine off and wait that the blade had come to a complete stop before adjusting the cutting height!

In more detail...

## Primer

The primer (11) is positioned in the front of the air filter case (10). Push the primer (11) 3 times before starting the cold engine (Fig. 15).

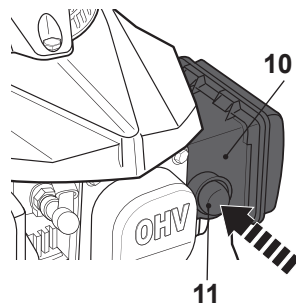

Fig. 15

## General operation

1. Before each use:
  - Check the product and accessories for damage and whether they are properly fixed. Do not use the product if it is damaged or shows signs of wear and tear. Take care of any problem you find or have the product checked by qualified specialist.
  - Check the fuel and oil level. Refill if necessary.
  - Look around and underneath the product for signs of oil or fuel spill.
  - Check each control for proper operation.
  - Check blade (27) for wear.
  - Make sure that all bolts and screws are tightened.
  - Check if the air filter (10a) is clean.
2. Always push the product using the upper handle bar (1). Keep the handle bar dry and free from lubricant to ensure safe support.
3. Ensure that the air vents (9) are always unobstructed and clear. Clean them if necessary with a soft brush. Blocked air vents may lead to overheating and damage the product.
4. Stop the engine immediately if you are disturbed while working by other people entering the working area. Always let the product come to a complete stop before leaving the product unattended.
5. Do not overwork yourself. Take regular breaks to ensure you can concentrate on the work and have full control over the product.

## Starting/Stopping



**WARNING!** Before starting, put the product on a flat surface free of high grass! Clean the underside of the deck!  
Start the engine carefully according to instructions. Keep your feet well away from the blade (27)!  
Do not tilt the product when starting the engine.

### Start

1. Press the primer (11) 3 times (Fig. 16, step 1).
2. Stand behind the upper handle bar (1).
3. Pull back the brake lever (2) and hold it against the upper handle bar (1) (Fig. 16, step 2).
4. Pull the recoil starter handle (25) lightly until you feel resistance then pull it rapidly. Do it repeatedly until the engine starts (Fig. 16, step 3).
5. Rest the recoil starter handle (25) onto the hook (24) located on the right-hand side of the upper handle bar (1).
6. The product begins mowing when you push the product forward.

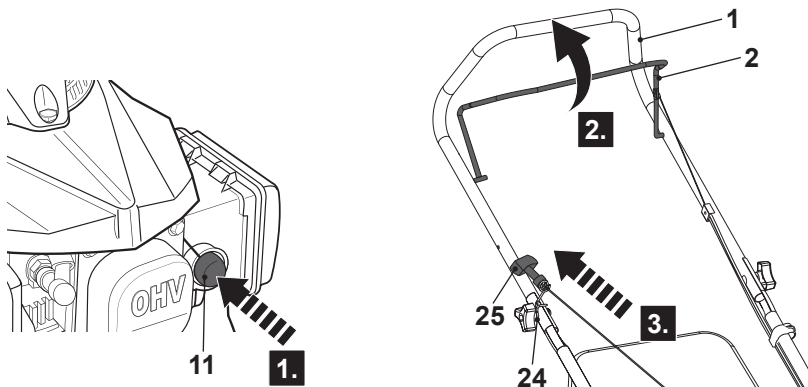

Fig. 16



**WARNING!** The starting position should be as described in the instruction manual. Fig. 17 A illustrates the defined starting position. The operator should start the engine behind the upper handle bar (1). Do not start the engine while standing on the side of the product as shown on Fig. 17 B.

In more detail...

## Starting/Stopping

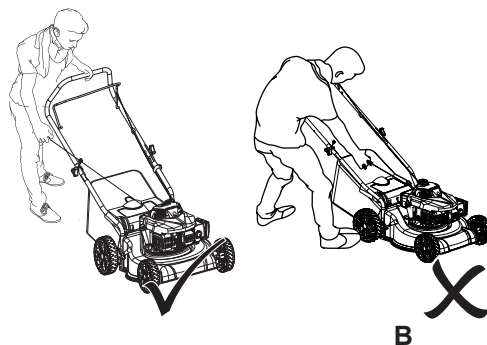

Fig. 17



**NOTE:** If the engine does not start, the engine may be flooded. Flooding is caused by too much fuel injected into the combustion chamber and can prevent a product from starting. Follow below procedure:

1. Remove the spark plug (15a) and dry it.
2. Pull the recoil starter handle (25) for several times to drain the fuel from the combustion chamber.
3. Wait until fuel vapours evaporate and refit the spark plug. Clean up any spilled fuel and move the product at least 3 metres (10') away before starting the engine to avoid any accidental fire. Wait for the engine to cool down then start the product as described in the "Start" section.

### Stopping

Release the brake lever (2) to stop the engine and blade (Fig. 18).

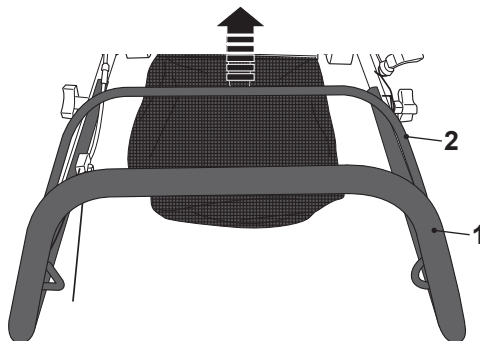

Fig. 18



## Mowing

1. Make sure that the lawn is clear of stones, sticks, wire or other objects that could damage the product or its engine.
2. Do not cut wet grass because it tends to stick to the underbody of the product, preventing the proper discharge of grass clippings, and it could also cause you to slip and fall.
3. Never cut off more than one-third of the total length of the grass for a healthy lawn. In the autumn, lawns should only be cut as long as there is growth.
4. Slowly push the product forward. You may want to use the self-propelled function for assistance.
5. Mow in slight overlapping rows. The most effective pattern for mowing lawns is straight lines along one of the sides. This will keep the rows even and ensures that all the lawn is cut without missing any spots (Fig. 19).
6. Circle around flower beds. When reaching a flower bed in the middle of the lawn, cut a row or two around the circumference of the bed.
7. Pay special attention when changing direction.
8. Empty the grass catcher (23) regularly.

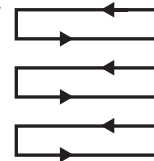

Fig. 19



**WARNING!** Extensive vibration of the product during operation is an indication of damage! Stop the engine immediately. The product should be promptly inspected and repaired!



**NOTE:** Fuel may leak from the fuel tank cap (8) and/or carburetor (13). Always ensure the fuel tank remains at a top position.

## After use

1. Stop the engine, disconnect the spark plug connector (15) and let it cool down.



**WARNING!** The spark plug (15a) will stay hot for a longer period of time after operation!

2. Check, clean and store the product as described below.

In more detail...

## The golden rules for care



**WARNING!** Proper maintenance is essential for safe and trouble free operation. Improper maintenance, or failure to address a problem instantly can cause a malfunction which can result in serious injury or even death.



**WARNING!** Always Stop the engine, disconnect the spark plug connector (15) and let the product cool down before performing inspection, maintenance and cleaning work!  
DO NOT touch a rotating blade (27).

1. Keep the product clean. Remove debris from it after each use and before storage.
2. Regular and proper cleaning will help ensure safe use and prolong the life of the product.
3. Inspect the product before each use for worn and damaged parts. Do not operate it if you find broken and worn parts. Replace worn parts as necessary or contact an authorised service centre for repair before using the product again.



**WARNING!** Only perform repairs and maintenance work according to these instructions! All further works must be performed by a qualified specialist!

## Cleaning

1. Clean the product with a slightly damp cloth and mild soap. Use a brush for areas that are hard to reach.
2. In particular clean the air vents (9) after every use with a cloth and brush.
3. Remove stubborn dirt with high pressure air (max. 3 bar).



**NOTE:** Do not use chemical, alkaline, abrasive or other aggressive detergents or disinfectants to clean this product as they might be harmful to its surfaces.

## Maintenance

Before and after each use, check the product and accessories (or attachments) for wear and damage. If required, exchange them for new ones as described in this instruction manual. Observe the technical requirements.

## Maintenance



**WARNING!** It requires to tip the product when performing maintenance, therefore the fuel tank must be empty otherwise the fuel can leak out and result in a fire or explosion.



**NOTE!** Always empty the fuel tank and keep the air filter (10a) upside. Otherwise the fuel or engine oil will contaminate the air filter (10a) / spark plug (15a) and cause difficulties to start the engine.

### Maintenance table

Part	To do	Before/ after each use	First month or 5 hours	Every 3 months or 25 hours	Every 6 months or 50 hours	Every year or 100 hours	Every 2 years or 250 hours
Engine oil	check	x					
	replace				x		
Air filter	check	x					
	clean			x			
	replace						x
Spark plug	check/ adjust			x		x	
	clean			x			
	replace						x
Spark plug cap	clean					x	
Fuel tank and filter	clean			x			
Fuel tube	clean	Every 2 years (replace if necessary)					
Valve clearance	check/ adjust					x	
Muffler	check					x	
	clean					x	
	replace					x	
Combustion chamber	clean	Every 200 hours					
Flywheel brake pad					x		

In more detail...

## Maintenance

### Underbody and cutting device



**WARNING!** Wear protective gloves when working on the cutting device (27) and close to it! Use proper tools to remove debris, e. g. a wooden stick! Never use your bare hands!

Always use original spare parts for replacement. The cutting device (27) must be replaced by an identification no. ref. 10012587. Do not attach any other type of cutting device!

The replacement of the cutting device (27) should be done by an experienced user! Rework or sharpening blades is not recommended unless it is done by a repair service or a similarly qualified specialist!



**NOTE:** We strongly recommend jacking the product when performing inspection and work on the cutting device (27). Avoid tilting the product in order to prevent fuel and oil leakages.

1. Keep the underbody and cutting device (27) clean and free of debris. Remove clippings from the rear discharge chute (26).
2. Check all nuts and bolts periodically for tightness before operation. After prolonged use, especially in sandy soil conditions, the cutting device (27) will become worn and lose some of the original shape. The cutting efficiency will be reduced and the cutting device should be replaced.
3. Keep the cutting device (27) sharp to ensure a good cutting performance. Replace a worn or damaged cutting device with a new one of the same type or have it sharpened by a qualified specialist.
4. If jacking the product is not possible, tilt it to the right side so that the fuel tank cap (10) side is up. This helps to prevent fuel leakage and harder starting due to flooding of the carburetor (13).
5. Loosen the hex bolt (27e) anticlockwise using a suitable wrench and remove it together with cup washer (27d), cutting device (27), blade holder (27c) and pin (27b) from the spindle (27a) (Fig. 20).
6. Replace the cutting device (27) with a new one of the same type. Slide the pin (27b) into the slot on the spindle (27a), then refit the blade holder (27c). Check the status of the flange onto the blade holder (27c), then attach the cutting device (27) properly, and fix it with cup washer (27d) and hex bolt (27e). Tighten the hex bolt clockwise with 40 Nm min, 50 Nm max. to ensure safe operation of your product (Fig. 20).



**DANGER!** If the cutting means (27) are not torqued properly, they could become loose and be thrown from the product and seriously hurt or kill the operator or bystanders.



**NOTE:** Replace this cutting device (27) after 50 hours mowing or 2 years whichever is sooner regardless of condition. If the cutting device is cracked or damaged, you must immediately replace it with a new one.

- Lubricate the cutting device (27) after each use to prolong the life span of both the cutting device and product. Apply lubrication oil/grease along the edges of the cutting means (27).

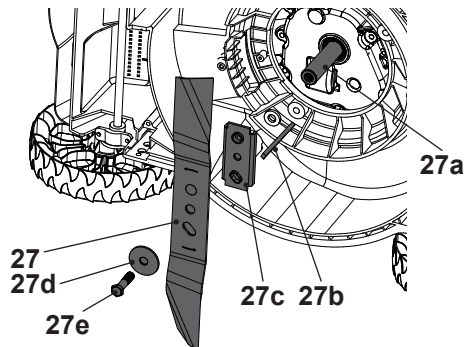

Fig. 20

### Grass catcher

- Inspect the grass catcher (23) before each use. Do not use it if you find any damage.
- Clean the grass catcher (23) after operation using water and mild soap.
- Let the grass catcher (23) dry thoroughly before storing to avoid mildew.

### Wires

Check the performance of the brake wire (3) before each use. Ask a qualified specialist to adjust it if necessary.



**WARNING!** Do not use the product with defective or loose wires!

### Air filter



**NOTE:** A properly maintained air filter (10a) helps to prevent dirt from entering the engine. Entering dirt can cause blockages that can lead to premature engine wear or problems with starting or running the engine.

In more detail...

## Maintenance

Wash the air filter (10a) every 25 hours (in dusty conditions or when airborne debris is present, clean more often).

1. Inspect the air filter (10a) regularly. Replace it with a new one if necessary.
2. Press the latches (10c) downwards to disengage and open the cover (10b) (Fig. 21).
3. Remove the air filter (10a) and tap it on a solid surface to remove dust.
4. Apply a small amount of foam air filter oil on the air filter (10a) to increase its performance. Wipe out surplus oil and put the air filter (10a) back into the air filter case (10).
5. Close the cover (10b) and ensure the latches (10c) engage properly.

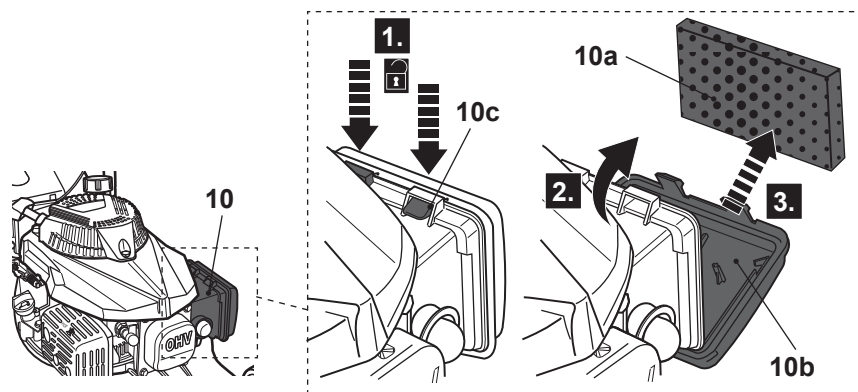

Fig. 21

### Spark plug



**NOTE:** For good performance, the spark plug (15a) must be properly gapped and free of deposits.

Inspect the spark plug (15a) every 25 hours or before long-term storage over 180 days. Clean or replace with a new one if necessary (type: F7RTC).

1. Disconnect the spark plug connector (15) (Fig. 22).
2. Loosen the spark plug anti-clockwise using the spark plug wrench (28) and remove it carefully (Fig. 23).

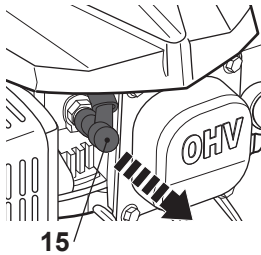

Fig. 22

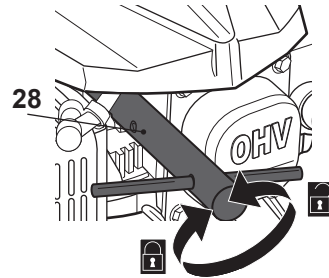

Fig. 23

3. Check the spark plug (15a) for damage and wear. The colour of the electrode should be light-brown.
4. Remove the deposits from the electrode with a soft wired brush. Avoid heavy cleaning of the electrode.
5. Dry the spark plug (15a) with a soft cloth, if it is wet from fuel.
6. Check the spark plug gap. It should be 0.7-0.8 mm (Fig. 24).
7. Replace with a new spark plug if either the electrode or the insulation is damaged.
8. When replacing the spark plug (15a), first screw it in hand tight and then lightly tighten it with the spark plug wrench (28).

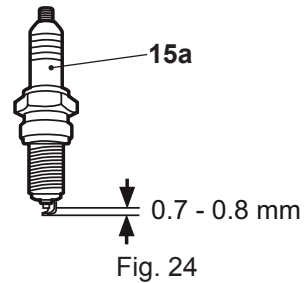

Fig. 24



**WARNING!** Do not over tighten the spark plug (15a) to avoid any damage!

## Fuel



**NOTE:** Petrol deteriorates over time. Engine starting may be difficult if you use petrol kept for more than 30 days.

1. Empty the fuel tank when storing the product over 30 days to prevent the fuel deteriorating.
2. Place a suitable container under the fuel drain screw (13a) to collect the fuel.
3. Unscrew the fuel drain screw (13a) and let the fuel run into the container (Fig. 25).
4. Screw the fuel drain screw (13a) back in and tighten it.
5. Wipe spilt fuel up.
6. Before re-use, refill the fuel tank as described in the "Fuel and engine oil - Fuel" section.

In more detail...

## Maintenance

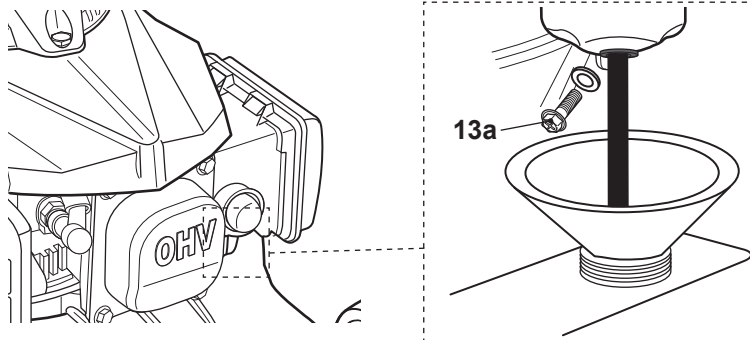

Fig. 25

### Checking engine oil



**NOTE:** Check the oil level and quality before each use. The oil must be replaced after every 6 months or after 50 hours of operation.

1. Unscrew and remove the oil tank cap (21).
2. Gradually add good-quality engine oil (SAE 10W-30). Allow the oil to settle.
3. Check the oil level frequently while filling. Wipe off oil dipstick and insert it into the tank opening without tightening the cap, and then remove the dipstick again.
4. The oil level must be between the oil level markings (approx. 400 ml). Add more oil if necessary. Do not overfill.
5. After filling oil, wait 1 minute and then recheck the oil level.
6. Wipe the spilt oil with a soft cloth and reattach the oil tank cap (21).

### Draining engine oil



**NOTE:** Drain the oil every 50 hours of operation or every 6 months.



**WARNING!** Before tilting the product for maintenance, the fuel tank must be empty, otherwise the fuel can leak out and result in a fire or explosion!

1. The oil should be clear and thick. If the oil is sticky or contains dirt particles, draining the oil is necessary.
2. Place a suitable container under the oil drain screw (21a) to collect the drained oil. Ensure the container has an efficient volume.



3. Loosen and remove the oil drain screw (21a) to empty the oil into the oil collecting container (Fig. 26).
4. Screw the oil drain screw (21a) back in and tighten it.
5. Wipe spilled oil up.
6. Tilt the product to the side to drain the oil into the oil container.
7. Refill the oil tank as described in the "Fuel and engine oil - Engine Oil" section.

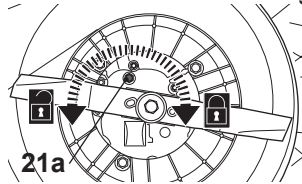

Fig. 26

## Carburettor

The carburetor (13) is preset by the manufacturer. Should it be necessary to make any changes, contact an authorised service center or a similarly qualified specialist. Do not attempt to make any adjustments by yourself.

## Muffler

Should it be necessary to modify or replace the muffler (16), contact an authorised service center or a similarly qualified specialist. Do not attempt to make any adjustments by yourself.

## Valve play

Have a qualified specialist check and adjust the valve play. Details for the specialist: **IN** = 0.08-0.12 mm, **EX** = 0.13-0.17 mm.

## Spare parts/Replacement parts

The following parts of this product may be replaced by the consumer. Spare parts are available at an authorised dealer or through our customer service.

Description	Model no. or Specification
Spark plug (15a)	F7RTC
Grass catcher (23)	10033466
Cutting blade (27)	LEO LM40-10012587

## Repair

---

This product does not contain any parts that can be repaired by the consumer. Contact an authorised service centre or a similarly qualified person to have it checked and repaired.

## Storage

---



**NOTE:** Good storage conditions are important for keeping your product trouble free.

1. Stop the engine and disconnect the spark plug connector (15).
2. Clean the product as described in the “Cleaning” section.
3. Store the product and its accessories in a dry, frost-free, well-ventilated place.
4. Always store the product in a place that is inaccessible to children. The ideal storage temperature is between 10°C and 30°C.
5. We recommend using the original package for storage or covering the product with a suitable cloth or enclosure to protect it against dust.
6. Empty the fuel tank if you are not going to use the product for an extended period of time (more than 30 days) and before storing it for the winter.

## Transportation

---

1. Stop the engine and disconnect the spark plug connector (15).
2. Adjust the cutting height to the highest position as described in the “Cutting height adjustment” section.
3. Attach transportation guards, if applicable.
4. Always transport the product by the upper handle bar (1).
5. If a suitable loading ramp is not available, ask another person for assistance when loading the product on a vehicle.
6. Protect the product from any heavy impact or strong vibrations which may occur during transportation in vehicles.
7. Secure the product to prevent it from slipping or falling over, loss of fuel, damage and injury.

## Troubleshooting

Suspected malfunctions are often due to causes that the users can fix themselves. Therefore check the product using this section. In most cases the problem can be solved quickly.



**WARNING!** Only perform the steps described within these instructions! All further inspection, maintenance and repair work must be performed by an authorised service centre or a similarly qualified specialist if you cannot solve the problem yourself!

Problem	Possible cause	Solution
1. Engine does not start	1.1. Not enough fuel in fuel tank 1.2. Spark plug is wet 1.3. Spark plug is damaged 1.4. Spark plug connector is loose 1.5. Air filter is dirty 1.6. Spark plug is loose 1.7. Spark plug gap is incorrect 1.8. Carburetor is flooded with fuel 1.9. Faulty ignition module	1.1. Add fuel 1.2. Dry spark plug 1.3. Replace spark plug 1.4. Attach properly 1.5. Clean air filter 1.6. Tighten spark plug 25-30 Nm 1.7. Set gap between electrodes at 0.7 to 0.8 mm 1.8. Remove the spark plug and pull recoil starter handle continuously until carburetor clears itself 1.9. Contact an authorised service agent
2. Engine stops	2.1. Not enough fuel in fuel tank 2.2. Cutting device is blocked	2.1. Add fuel 2.2. Remove blockage
3. Engine difficult to start or loses power	3.1. Dirt, water or stale fuel in the tank 3.2. Vent hole in fuel tank cap is clogged 3.3. Air filter is dirty	3.1. Drain fuel and clean tank. Fill tank with clean, fresh fuel 3.2. Clean or replace fuel tank cap 3.3. Clean air filter

In more detail...

## Troubleshooting

Problem	Possible cause	Solution
4. Engine operates erratically	4.1. Spark plug is defective 4.2. Spark plug gap is incorrect 4.3. Air filter is dirty	4.1. Install new, correctly gapped plug 4.2. Set gap between electrodes at 0.7 to 0.8 mm 4.3. Clean air filter
5. Engine idles poorly	5.1. Air filter is dirty 5.2. Air vents are clogged 5.3. Cylinder fins are blocked	5.1. Clean air filter 5.2. Remove debris from vents 5.3. Remove debris from cylinder fins
6. Engine skips at high speed	6.1. Gap between electrodes of spark plug is too close	6.1. Set gap between electrodes at 0.7 to 0.8 mm
7. Engine overheats	7.1. Air vents are clogged 7.2. Incorrect spark plug	7.1. Remove debris from vents 7.2. Install correct spark plug and cylinder fins on engine
8. Unsatisfactory result	8.1. Cutting device is dull 8.2. Cutting material exceeds capacity 8.3. Cutting height is incorrect	8.1. Replace with a new one 8.2. Only cut materials acc. to the capacity of the product 8.3. Adjust cutting height
9. Excessive vibration/noise or exhaust	9.1. Cutting device is dull/damaged 9.2. Bolts/nuts are loose 9.3. Petrol/oil type is incorrect	9.1. Replace with a new one 9.2. Tighten bolts/nuts 9.3. Drain the petrol/oil and refill with the correct petrol/oil

In more detail...

## Recycling and disposal

Old products are potentially recyclable and do not, therefore, belong in your household rubbish. You are requested to assist us and our contribution to saving resources and protecting the environment by handing in this product at an equipped collection centre (if there is one available).

Petrol, oil, used oil, a mixture of oil and petrol and objects soiled with oil e. g. cleaning cloths do not belong in the household rubbish. Dispose of oil-contaminated items in accordance with the local guidelines and hand them in at recycling centres.

The product comes in a package that protects it against damage during shipping. Keep the package until you are sure that all parts have been delivered and the product is function properly. Recycle the package afterwards.

## Guarantee

This product carries a guarantee of 24 months starting from the day of purchase. Please retain your receipt as a proof.

This guarantee specifically excludes losses due to:

- Normal wear and tear, including accessory wear
- Overload, misuse or neglect
- Failure of consumable items (such as batteries)
- Repairs attempted by anyone other than an authorised agent
- Accidental damage caused by foreign objects or substances
- Lack of routine maintenance
- Failure to follow manufacturer's guidelines
- Loss of use of the goods

Due to continuous product improvement, we reserve the right to change the product specification without prior notice.

This guarantee does not affect your statutory rights.

For any inquiries relating to the guarantee please contact your retailer: If you purchased this product in B&Q store or website then call 0333 0143101. If you bought this product in SFX outlet or website then call 03330 112 112.



(9:00 a.m. ~ 17:00 p.m.)

EN

**0333 2000 339**  
**cs@b-gr8.co.uk**

In more detail...



(EN) EU DECLARATION OF CONFORMITY  
 (FR) DÉCLARATION UE DE CONFORMITÉ  
 (PL) DEKLARACJA ZGODNOŚCI UE  
 (RO) DECLARAȚIA DE CONFORMITATE UE  
 (ES) DECLARACIÓN UE DE CONFORMIDAD  
 (PT) DECLARAÇÃO DE CONFORMIDADE UE

Product/ Produit/ Produkt/Produsul/Produkt/Producto/Produto

- Petrol lawnmower/Tondeuse à gazon thermique/Kosiarka spalinowa/Mașină de tuns iarba cu benzină/Cortacésped de gasolina/Cortador de grama a gasolina
- FPLMP99H-4
- 99cm<sup>3</sup>, 1,2kW
- 000001 to 999999

Name and address of the manufacturer or his authorised representative:

Nom et adresse du fabricant ou de son mandataire:

Nazwa i adres producenta lub jego upoważnionego przedstawiciela:

Denumirea și adresa producătorului sau a reprezentantului său autorizat:

Nombre y dirección del fabricante o de su representante autorizado:

Nome e endereço do fabricante ou do respetivo mandatário:

Kingfisher International Products B.V.,  
 Rapenburgerstraat 175E,  
 1011 VM Amsterdam,  
 The Netherlands

This declaration of conformity is issued under the sole responsibility of the manufacturer.

La présente déclaration de conformité est établie sous la seule responsabilité du fabricant.

Niniejsza deklaracja zgodności wydana zostaje na wyłączną odpowiedzialność producenta.

Prezenta declarație de conformitate este emisă pe răspunderea exclusivă a producătorului.

La presente declaración de conformidad se expide bajo la exclusiva responsabilidad del fabricante.

A presente declaração de conformidade é emitida sob a exclusiva responsabilidade do fabricante.

Object of the declaration/Objet de la déclaration/Przedmiot deklaracji/Obiectul declarației/Gegenstand der Erklärung/Objeto de la declaración/Objeto da declaração

Product/Produit/Produkt/Produsul/Produkt/  
 Producto/ Produto

Model/Modèle/Model/  
 Modelul/Modell/Modelo/  
 Modelo

EAN

Petrol lawnmower/Tondeuse à gazon thermique/  
 Kosiarka spalinowa/Mașină de tuns iarba cu  
 benzină/Cortacésped de gasolina/Cortador de  
 grama a gasolina

FPLMP99H-4

5059340124551

The object of the declaration described above is in conformity with the relevant Union harmonisation legislation:

L'objet de la déclaration décrit ci-dessus est conforme à la législation d'harmonisation de l'Union applicable:

Wymieniony powyżej przedmiot niniejszej deklaracji jest zgodny z odnośnymi wymaganiami unijnego prawodawstwa harmonizacyjnego:

Obiectul declarației descris mai sus este în conformitate cu legislația relevantă de armonizare a Uniunii:

El objeto de la declaración descrita anteriormente es conforme con la legislación de armonización pertinente de la Unión:

O objeto da declaração acima descrito está em conformidade com a legislação de harmonização da União aplicável:

2006/42/EC as amended Machinery Directive  
 2014/30/EU as amended Directive Electromagnetic compatibility  
 2000/14/EC as amended Outdoor Noise Directive  
 2016/1628/EU Regulation Gaseous and Particulate Pollutant Emission Limits  
 2011/65/EU as amended Directive Restriction of the use of certain hazardous substances in electrical and electronic equipment

2006/42/CE telle que modifiée Directive sur les machines  
 2014/30 / UE telle que modifiée Directive Compatibilité électromagnétique  
 2000/14/CE telle que modifiée Directive relative aux émissions sonores dans l'environnement des matériels destinés à être utilisés à l'extérieur des bâtiments  
 2016/1628/UE Règlement relatif aux exigences concernant les limites d'émission pour les gaz polluants et les particules polluantes  
 2011/65/UE telle que modifiée Directive relative à la limitation de l'utilisation de certaines substances dangereuses dans les équipements électriques et électroniques

2006/42/WE w zmienionej dyrektywie maszynowej  
 2014/30 / UE ze zmianami Dyrektywa Kompatybilność elektromagnetyczna  
 2000/14/WE w zmienionej dyrektywie w sprawie hałasu na zewnątrz  
 2016/1628/UE limity emisji zanieczyszczeń gazowych i cząstek stałych  
 2011/65 / UE ze zmianami Dyrektywa Ograniczenie stosowania niektórych niebezpiecznych substancji w sprzęcie elektrycznym i elektronicznym

2006/42/CE, astfel a fost modificată Directiva privind echipamentele  
 2014/30/UE, astfel a fost modificată Directiva privind compatibilitatea electromagnetică  
 2000/14/CE, astfel a fost modificată Directiva privind zgomotul în aer liber  
 2016/1628/UE Regulamentul privind emisiile de poluanți gazoși și de particule poluante  
 2011/65/UE, astfel a fost modificată Directiva privind limitarea utilizării anumitor substanțe periculoase în echipamentele electrice și electronice

Directiva sobre maquinaria modificada 2006/42/CE  
 2014/30/UE modificada Directiva Compatibilidad electromagnética  
 2000/14/CE modificada Directiva sobre ruido al aire libre  
 2016/1628/Reglamento de la UE Límites de emisiones de contaminantes gaseosos y partículas  
 2011/65/UE modificada Directiva Restricción del uso de determinadas sustancias peligrosas en equipos eléctricos y electrónicos

2006/42/CE como diretiva de máquinas alteradas  
 2014/30/UE como alteração da compatibilidade eletromagnética  
 2000/14/CE como diretiva de ruído exterior alterada  
 Limites de emissão de poluentes gasosos e de poluentes de partículas 2016/1628/REGULAMENTO da UE  
 2011/65/UE como restrição diretiva alterada da utilização de certas substâncias perigosas em equipamentos elétricos e eletrônicos

Measured Sound Power Level  
 Niveau de puissance acoustique mesuré  
 Zmierzony poziom mocy akustycznej  
 Nivel de putere acustică măsurat  
 Gemessener Schalleistungspegel  
 Nivel de potencia sonora medido  
 Nivel de potência sonora medido  
 : 91,0 dB(A)  
 Engine Model  
 Modèle de moteur  
 Model silnika  
 Modelul motorului  
 Modelo de motor  
 Modelo de motor  
 : GP99

Guaranteed Sound Power Level  
 Niveau de puissance acoustique garanti  
 Gwarantowany poziom mocy akustycznej  
 Nivel de putere acustică garantat  
 Garantierter Schalleistungspegel  
 Nivel de potencia sonora garantizado  
 Nivel de potência sonora garantido  
 : 96 dB(A)

Notified body/ Organisme notifié/ Jednostka notyfikowana / Prganism notificat / Organismo notificado / Organismo notificado: TÜV Rheinland LGA GmbH, No.0197

Certificate registration number/ Numéro d'enregistrement du certificat/Number rejestracyjny certyfikatu /Nr.de inregistrare a certificatului / Numero de registro del certificado / Numero do certificado de registo: JO 60142970 0001

In more detail...

Test report No./ Numéro du rapport de test/ Numer raportu / Raport test nr. / N.O del informe de prueba / Ralatorio de teste no : 50280171 001

Conformity assessment procedures: Annex VI of the directive / Procédures d'évaluation de conformité : Annexe VI de la Directive/ Procedury oceny zgodności: Załącznik VI dyrektywy / Proceduri de evaluare a conformitatii: Anexa VI a directivei / Procedimientos de evaluacion de la conformidad : Anexo VI de la directiva / Procedimentos de avaliacao de conformidade: Anexo VI da diretiva

References to the relevant harmonised standards used or references to the other technical specifications in relation to which conformity is declared:

Références des normes harmonisées pertinentes appliquées, y compris la date de celles-ci, ou des autres caractéristiques techniques, y compris la date de celles-ci, par rapport auxquelles la conformité est déclarée:

Odwolania do odnośnych norm zharmonizowanych, które zastosowano, wraz z datą normy, lub do innych specyfikacji technicznych, wraz z datą specyfikacji, w odniesieniu do których deklarowana jest zgodność:

Trimiteri la standardele armonizate relevante folosite, inclusiv data standardului, sau trimiteri la celelalte specificații tehnice, inclusiv data specificațiilor, în legătură cu care se declară conformitatea:

Angabe der einschlägigen harmonisierten Normen, die zugrunde gelegt wurden, oder Angabe der anderen technischen Spezifikationen, in Bezug auf die die Konformität erklärt wird:

Referencias a las normas armonizadas pertinentes utilizadas, incluidas las fechas de las normas, o referencias a las otras especificaciones técnicas, incluidas las fechas de las especificaciones, respecto a las cuales se declara la conformidad:

Referências às normas harmonizadas aplicáveis utilizadas, incluindo a data da norma, ou às outras especificações técnicas, incluindo a data da especificação, em relação às quais é declarada a conformidade:

EN ISO 5395-1:2013+A1

EN ISO 5395-2:2013+A1+A2

EN ISO 14982:2009

EN ISO 3744: 1995

ISO 11094: 1991

Authorized Signatory and technical file holder/ Signataire et responsable de la documentation technique autorisé/ Podmiot uprawniony do wystawienia i adres przechowywania dokumentacji technicznej/ Semnatar autorizat și deținătorul dosarului tehnic/ Firmante autorizado y titular del expediente técnico/ Signatário autorizado e detentor da ficha técnica:

Kingfisher International Products B.V.,  
Rapenburgerstraat 175E,  
1011 VM Amsterdam,  
The Netherlands

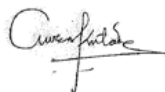

David Awe  
Group Quality & Sustainability Director

8/11/2020





**Manufacturer, Fabricant, Producent,  
Producător, Fabricante:**

Kingfisher International Products Limited  
3 Sheldon Square, London, W2 6PX  
United Kingdom  
[www.kingfisher.com/products](http://www.kingfisher.com/products)

Kingfisher International Products B.V.  
Rapenburgerstraat 175E  
1011 VM Amsterdam  
The Netherlands  
[www.kingfisher.com/products](http://www.kingfisher.com/products)



[www.diy.com](http://www.diy.com)

[www.screwfix.com](http://www.screwfix.com)

[www.screwfix.ie](http://www.screwfix.ie)

To view instruction manuals online,  
visit [www.kingfisher.com/products](http://www.kingfisher.com/products)

---